

INST_80_1

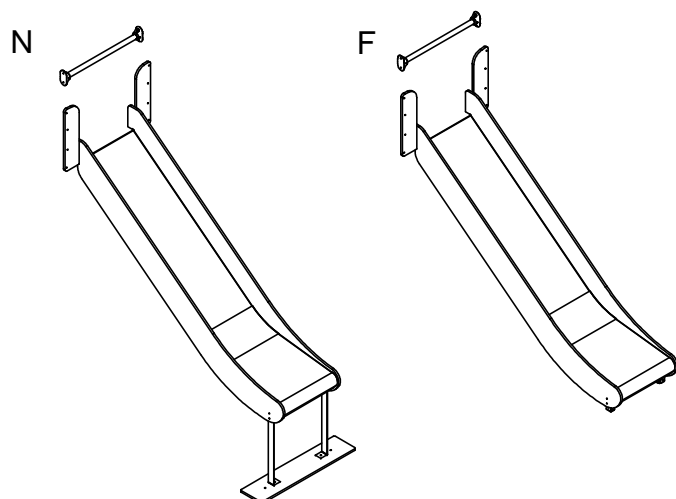

1 N,F

A-A

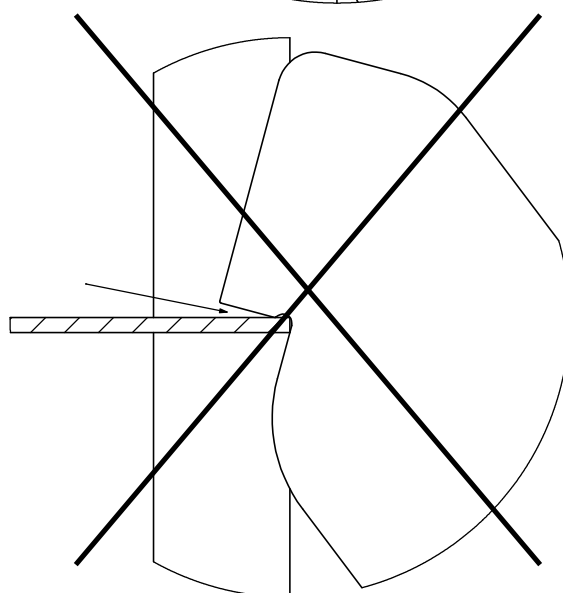
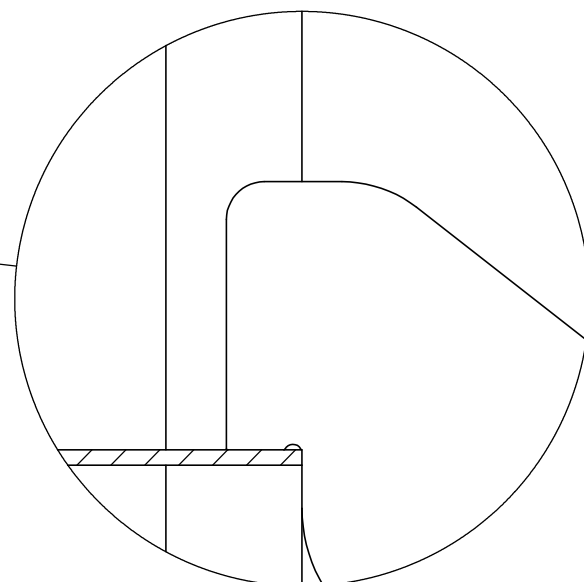
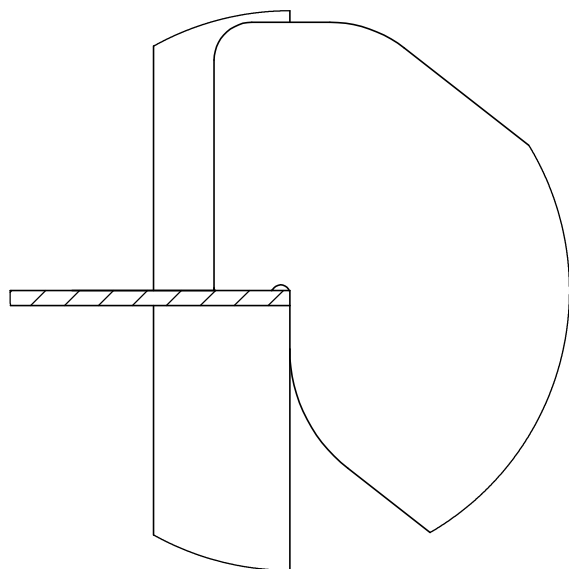
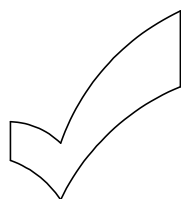
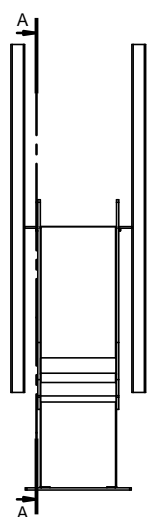

Nr:	Σ	Element:	
1	12x	S6x60	
2	8x	W6x60	
21	12x	DIN 125 - 8x16	
22	8x	DIN 125 - 6x12	
24	8x	ISO 7380 - M6x16	
29	4x	K_5_A2_g2_G_v2	
109	4x	DIN 913 10x10	
147	8x	BN M6x10	
149	2x	ALUZ SD	

2 N,F

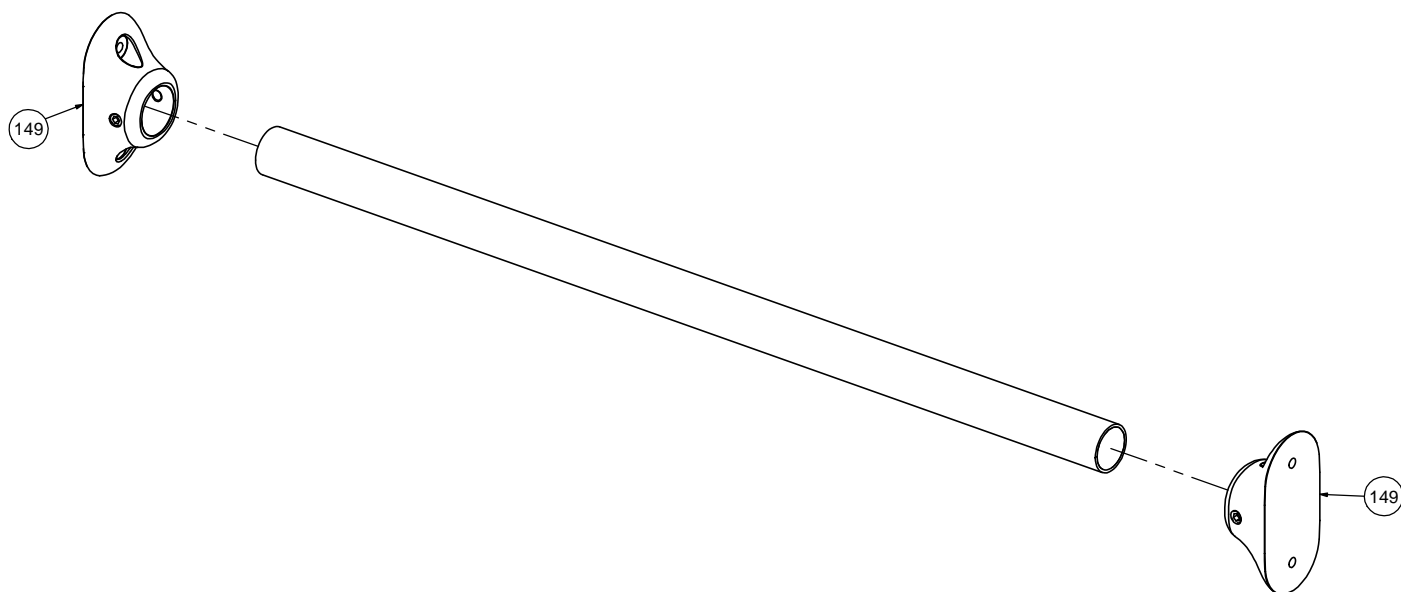

3 N,F

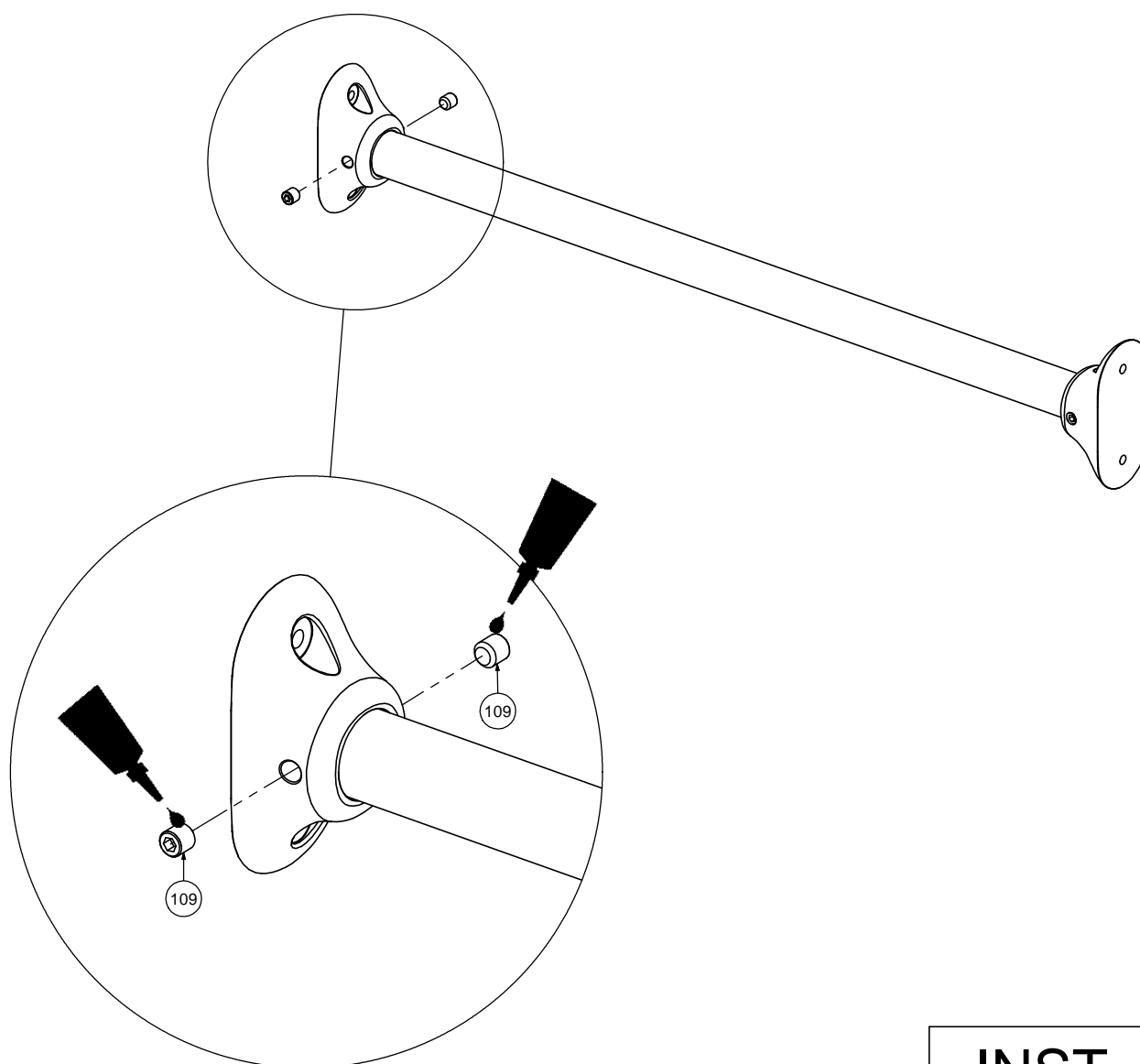

4 N,F

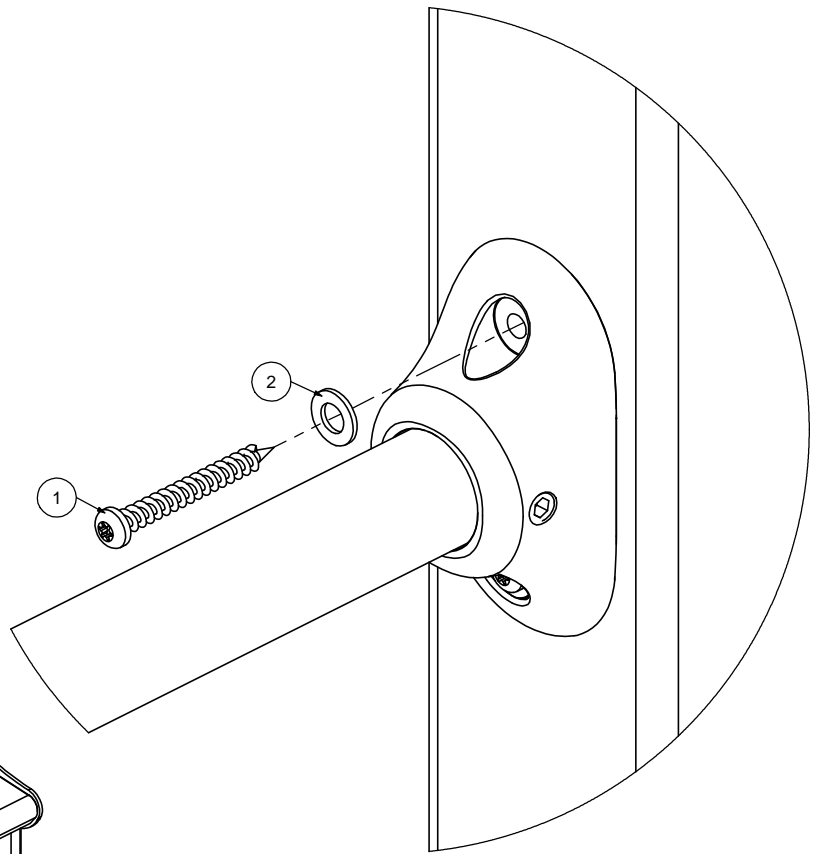
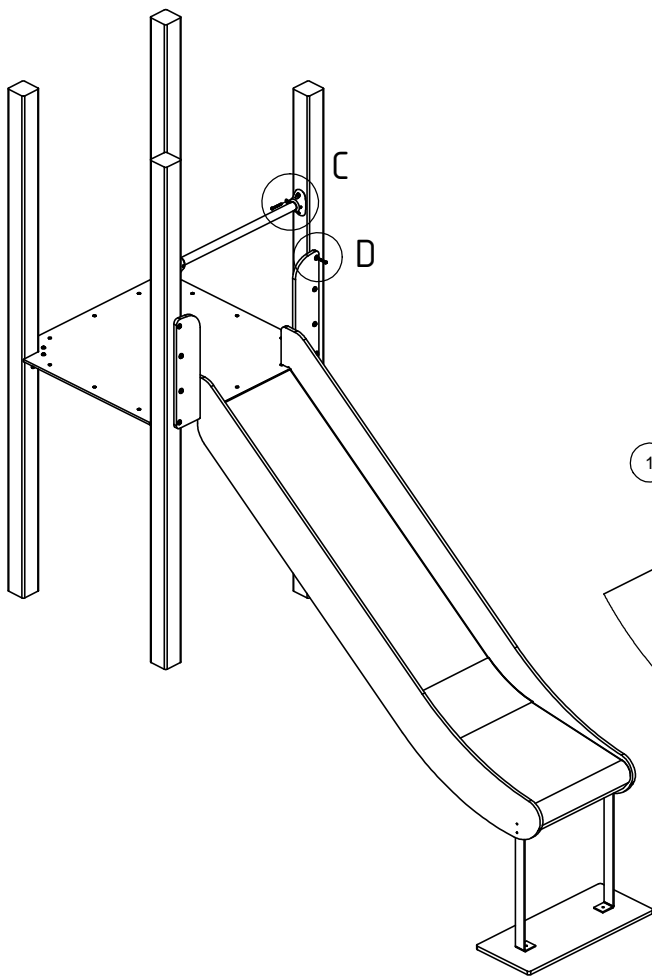

D (1 : 2)

5 N,F

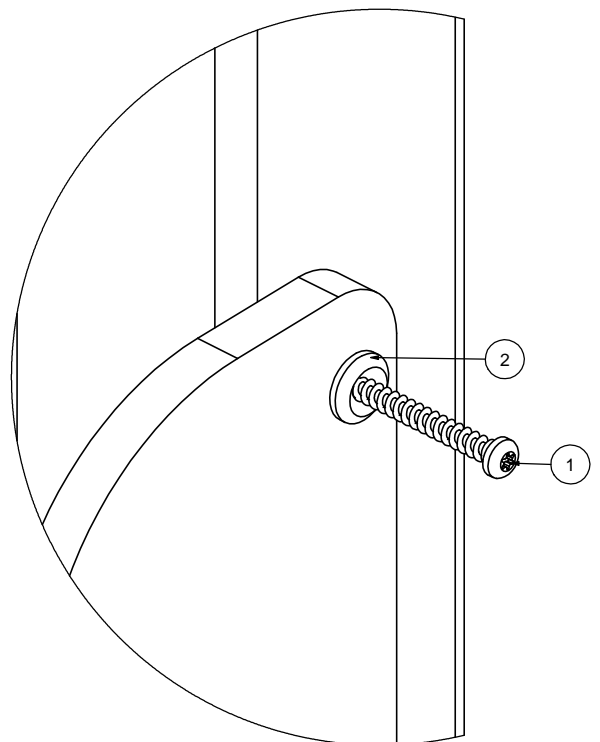
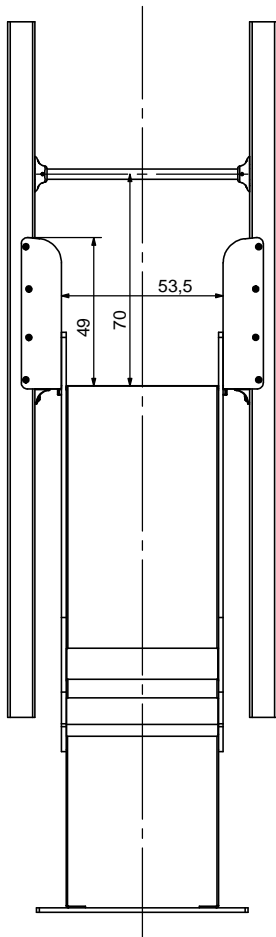

6 N,F

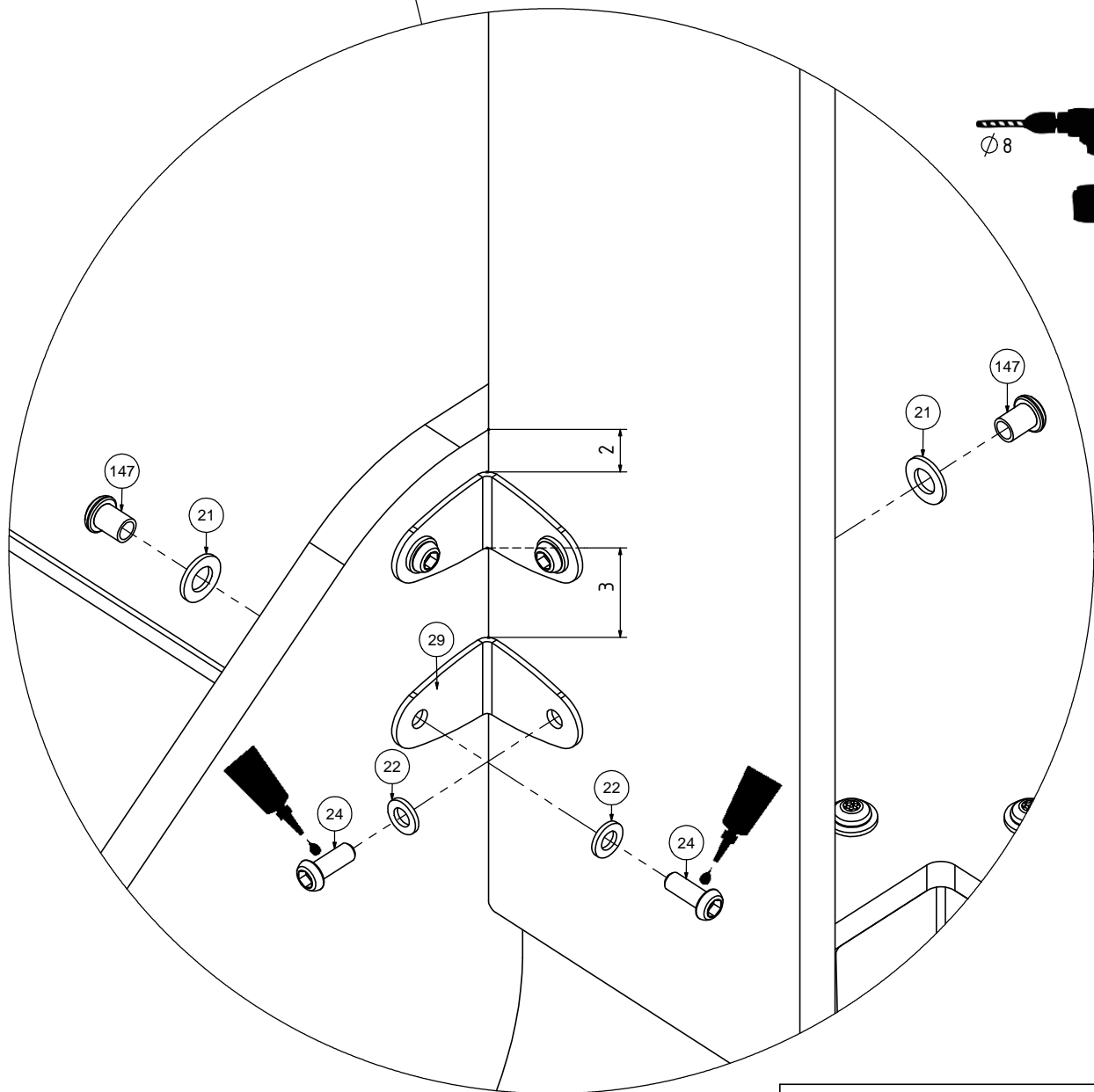
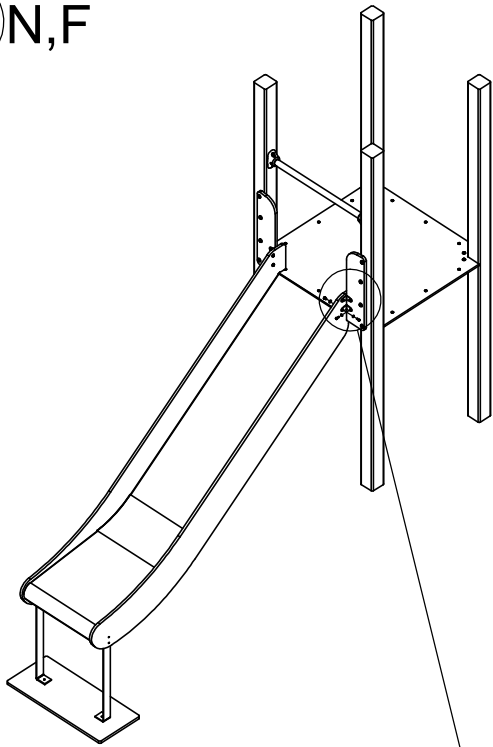

F - SL140

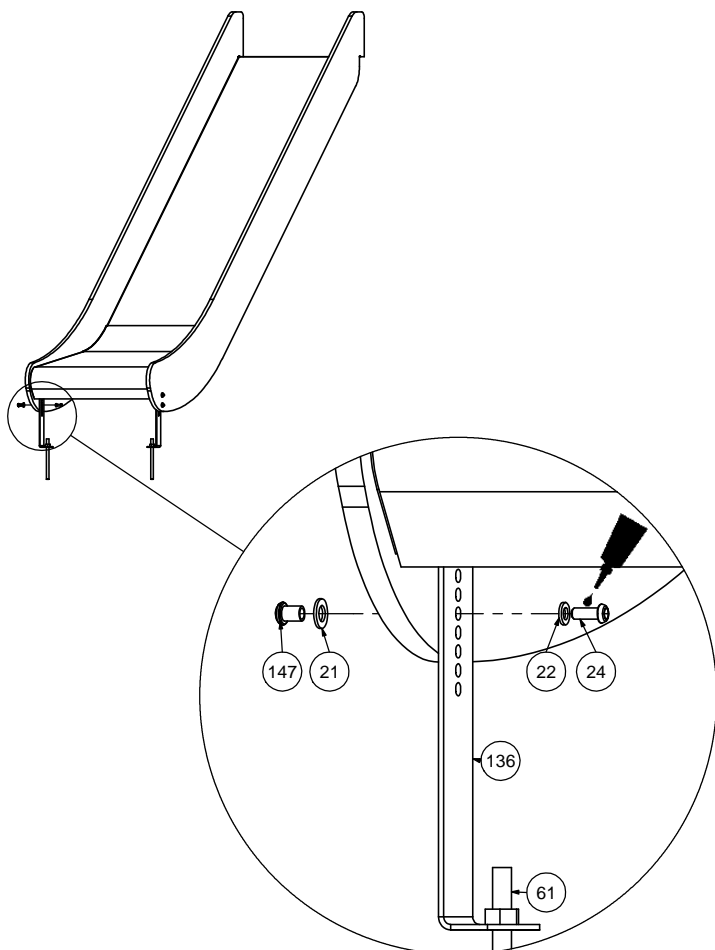

Nr:	Σ	Element:	
21	4x	DIN 125 - 8x16	
22	4x	DIN 125 - 6x12	
24	4x	ISO 7380 - M6x16	
61	2x	KL105	
136	2x	1100_6_A2_g3_G_v1	
147	4x	BN M6x10	

F - SL60, SL90, SL120, SL180

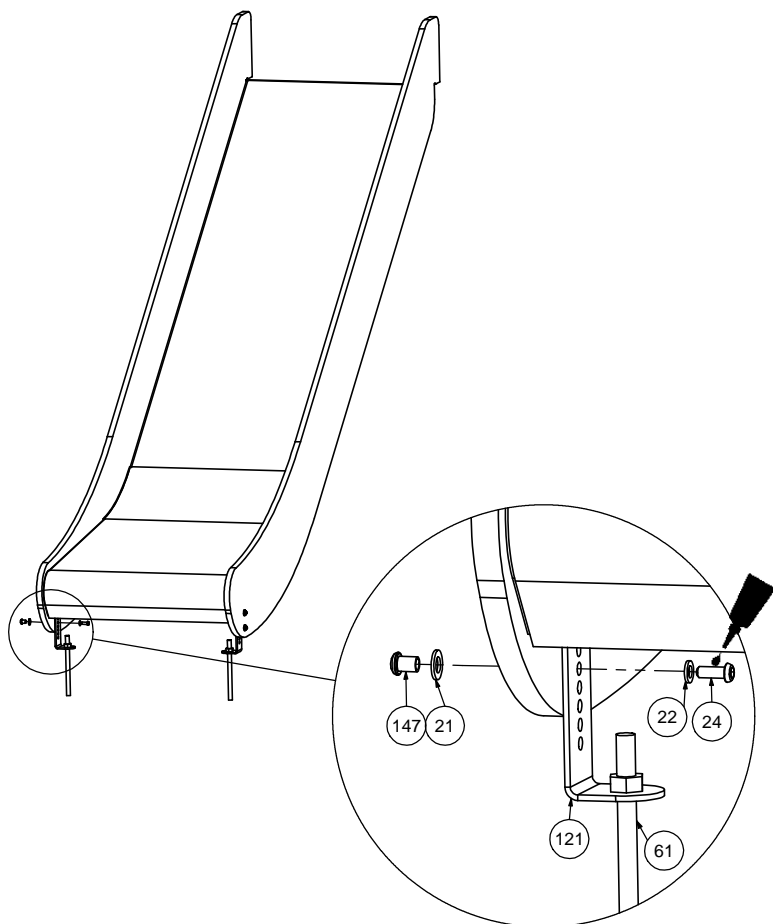

Nr:	Σ	Element:	
21	4x	DIN 125 - 8x16	
22	4x	DIN 125 - 6x12	
24	4x	ISO 7380 - M6x16	
61	2x	KL105	
136	2x	7100_5_A2_g3_G_v1	
147	4x	BN M6x10	